

pflug.



*Driving gear and conveyor
technology
Profiled belts
Continuous round belts
turned and plaited*

PU V-ledges belts

EU/FDA compliant



PU V-ledge belts

In the width division 17,5 mm

By dividing the guide wedge in several small wedges considerably smaller deflection diameter can be realized compared to belts with only one large central guide wedge.

Thus, the lateral transverse forces are spread evenly over the entire width of the belt.

Easy to guide and absolutely true to track.

Due to the large selection of our types you may find right belt for every application.

All types are EU/FDA compliant according to EC directive 1935/2004 and 2002/72/EC or EU VO No. 10/2011 as well as the FDA guideline CFR Title 21 of the US Food and Drug Administration for direct contact with unpackaged food.

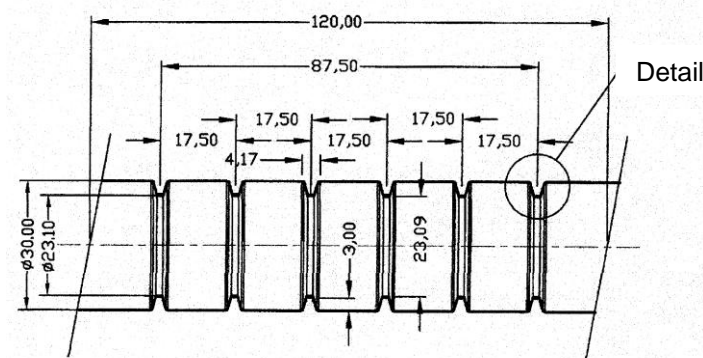

Roller profile

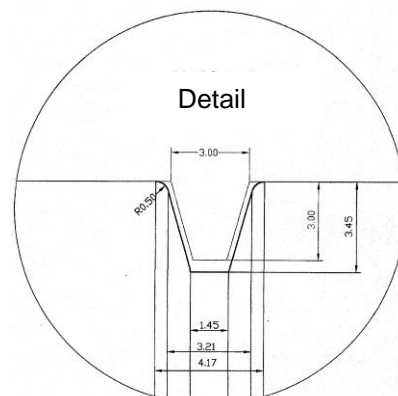

Wedge stitch

Belt types

Typ	Minimum pulley-diameter	Pre-tension recommended	Tracking force ² in N per 17,5 mm width at 2% preload	Available widths
314 60 Sh.A ultramarine blue, EU/FDA	25 mm	2 %	7,2 N	17,5 – 105 mm
315 70 Sh.A sapphire, EU/FDA	30 mm	2 %	10,8 N	17,5 – 105 mm
316 75 Sh.A sky blue, EU/FDA	35 mm	2 %	21,6 N	17,5 – 105 mm
317 80 Sh.A transparent, EU/FDA	40 mm	2 %	18,6 N	17,5 – 105 mm
318 85 Sh.A ultramarine blue, EU/FDA	40 mm	2 %	20,8 N	17,5 – 105 mm
319 90 Sh.A white EU/FDA	50 mm	2 %	25,6 N	17,5 – 105 mm

² Dynamically tested at 2000 r/min.

Material properties

Type	Adhesion	Friction coefficient ¹ μ to V2A Steel / Murtfeld S green ground Superfinish		Temperature-resistant °C	Tensile strength MPa DIN 53504-S2 / ISO 37	Abrasion mm ³ DIN ISO 4649-A
60 Sh.A ultramarine blue, EU/FDA	very high	0,70 μ	0,40 μ	-30°C - +55°C	26	44
70 Sh.A sapphire, EU/FDA	very high	0,65 μ	0,40 μ	-35°C - +60°C	30	45
75 Sh.A sky blue, EU/FDA	high	0,60 μ	0,40 μ	-20°C - +60°C	45	30
80 Sh.A transparent, EU/FDA	high	0,55 μ	0,30 μ	-20°C - +60°C	45	25
85 Sh.A ultramarine blue, EU/FDA	average	0,55 μ	0,30 μ	-20°C - +60°C	45	25
90 Sh.A white, EU/FDA	low	0,45 μ	0,25 μ	-15°C - +70°C	50	25

¹ According to Pflug test specification SPPN 91.001

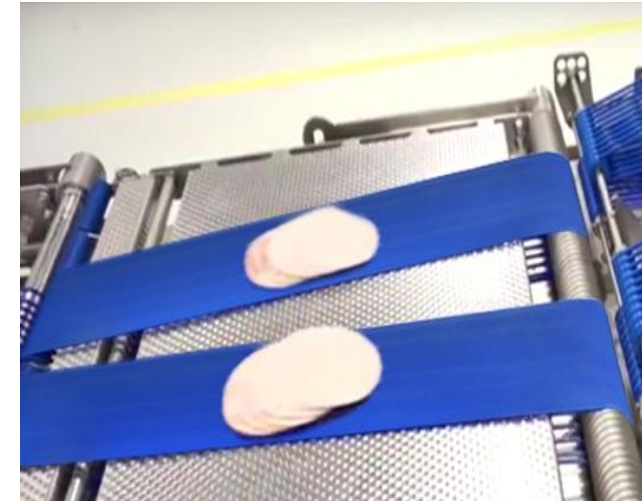

Our FDA/EU-compliant types are characterized by:

- excellent resistance to hydrolyses
- very good resistance to microbes
- particularly suitable for the use in wet areas
- highly abrasion-resistant
- high flexibility at low temperatures
- available from 60 Sh.A – 90 Sh.A
- easy to clean

V-ledge belts are manufactured ex works from 320 mm with finger-joints and shape-welding³.

This guarantees smooth running, even under mechanical stress or small deflections.

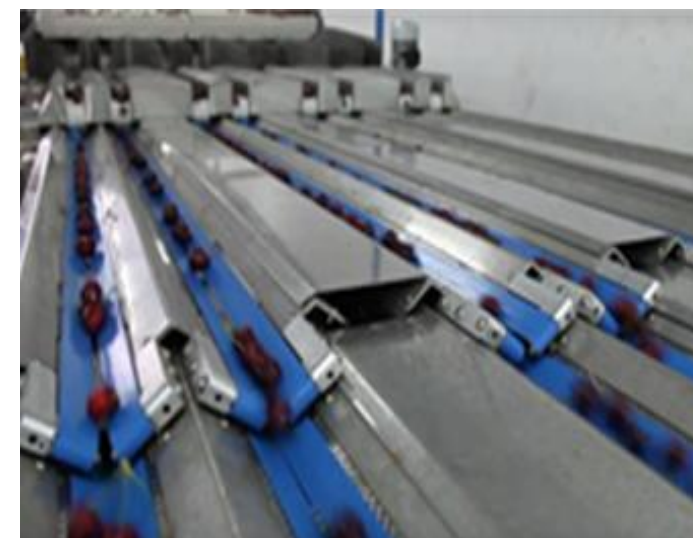
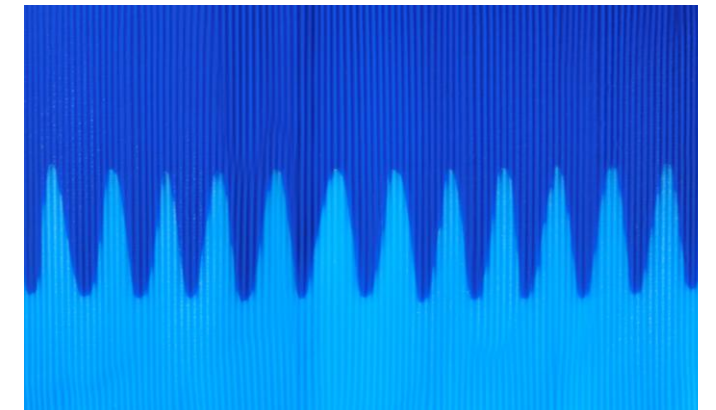

V-ledge belts in washing and sorting units for fruits

³ European Patent No. 2 957 419

pflug. Antriebs- und Förderer-
technologie
Prüfungsdienste
Continuum round belts
turned and plated

Company profile



pflug. Antriebs- und Förderer-
technologie
Prüfungsdienste
Continuum round belts
turned and plated

Testing Service



pflug. Antriebs- und Förderer-
technologie
Prüfungsdienste
Continuum round belts
turned and plated

**Welded timing belts
in short lengths**



pflug. Antriebs- und Förderer-
technologie
Prüfungsdienste
Continuum round belts
turned and plated

**Round belts for
heat-setting machines**



pflug. Antriebs- und Förderer-
technologie
Prüfungsdienste
Continuum round belts
turned and plated

Endless injected round belts



pflug. Antriebs- und Förderer-
technologie
Prüfungsdienste
Continuum round belts
turned and plated

Endless turned round belts

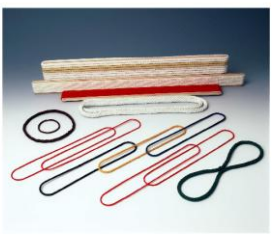

pflug. Antriebs- und Förderer-
technologie
Prüfungsdienste
Continuum round belts
turned and plated

Endless plaited round belts



pflug. Antriebs- und Förderer-
technologie
Prüfungsdienste
Continuum round belts
turned and plated

Hooked belts



pflug. Antriebs- und Förderer-
technologie
Prüfungsdienste
Continuum round belts
turned and plated

PU round- and profile belts



pflug. Antriebs- und Förderer-
technologie
Prüfungsdienste
Continuum round belts
turned and plated

**PU profile belts and
special profiles**



pflug. Antriebs- und Förderer-
technologie
Prüfungsdienste
Continuum round belts
turned and plated

**PU tracking guides, cleats
and guides**

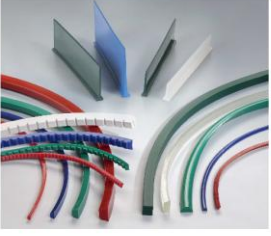

pflug. Antriebs- und Förderer-
technologie
Prüfungsdienste
Continuum round belts
turned and plated

Food line
Types for the food industry compliant to EU/FDA



pflug. Antriebs- und Förderer-
technologie
Prüfungsdienste
Continuum round belts
turned and plated

PU cleats and block profiles

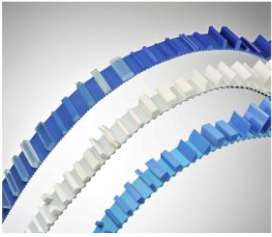

pflug. Antriebs- und Förderer-
technologie
Prüfungsdienste
Continuum round belts
turned and plated

PU Poly-V belts



pflug. Antriebs- und Förderer-
technologie
Prüfungsdienste
Continuum round belts
turned and plated

**PU-V-guide belts
compliant to EU/FDA**



pflug. Antriebs- und Förderer-
technologie
Prüfungsdienste
Continuum round belts
turned and plated

PU coatings



© Copyright Any duplication, processing, distribution or any form of utilization requires our prior written consent.

**Pflug Antriebs- und Förderer-
Lange Str. 38
D-89547 Gerstetten-Deitingen**

**Phone: 0049 (0)7324/5413
Fax: 0049 (0)7324/5316**

**E-Mail: info@seilerei-pflug.de
HP: www.seilerei-pflug.com**

Effective 09/2023